



Al Mustapha Institute

# Islamic Educational & Cultural Centre

# CONTENTS

1. The Islamic Educational and Cultural Centre
2. Services Provided
3. Location
4. Functional Organisation
5. Building Inclusions
6. Building Layout
7. Building Cost
8. How You Can Help

# 1 ISLAMIC EDUCATIONAL AND CULTURAL CENTRE

Al Mustapha Institute is building the first Islamic Educational and Cultural Centre in Queensland, Australia.

The Institute will provide richly interactive and personalised learning experiences for students, equipping them with leadership skills for the future and valuing them as partners in education and research and as long-term influencers of positive change within society.

Influencing research in areas of strategic importance, we will deliver outcomes of significant value to our communities locally, nationally and globally.



## 2 SERVICES PROVIDED

Al Mustapha Institute is developing an Islamic Educational and Cultural Centre to be a recognised service provider in Islamic research and education whilst delivering outcomes of significant value to the community. These include and are not limited to:

- Education for Muslims and non-Muslims of all ages
- Prayer facilities
- Revert induction and learning programs
- Spiritual guidance, counselling and support for major community issues including domestic violence and youth development
- Charitable events
- Community workshops and functions

### 3 LOCATION

Al Mustapha Institute will provide land for the Islamic Educational and Cultural Centre valued at over \$1.3 million, located in Queensland, Australia.

It will create an inviting space for the community in the heart of a thriving commercial, retail and residential precinct.

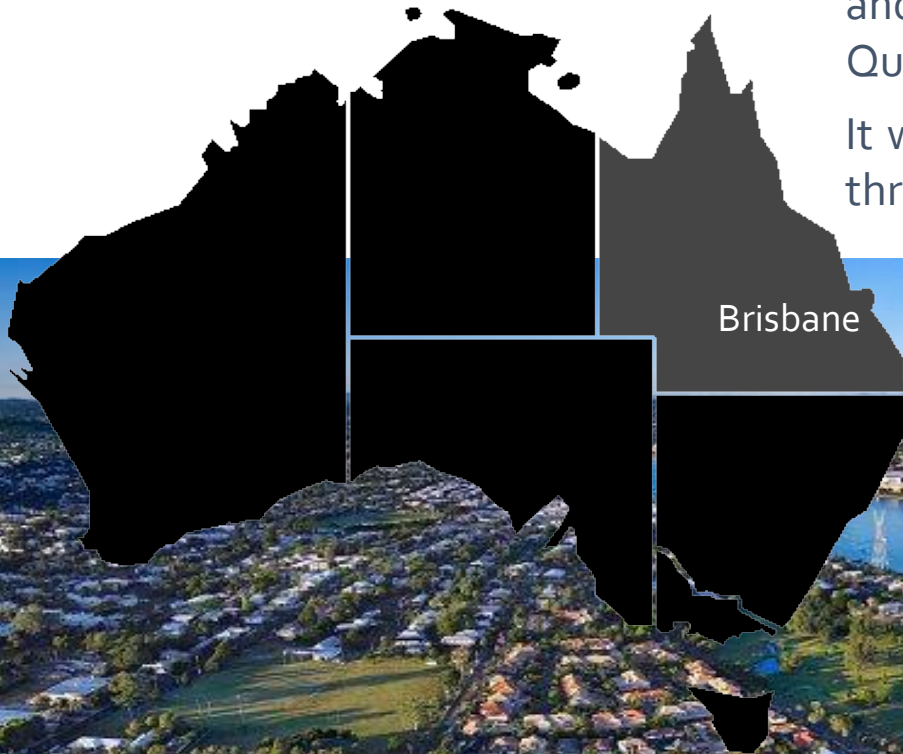

## 4 FUNCTIONAL ORGANISATION

The functions in the building are based on two principles.

The educational and prayer facilities are in the main building while amenities, kitchen and ghusl facilities are located in an adjoining building.

Both buildings are connected by a stylish undercover area that serves as a gathering point for community events.

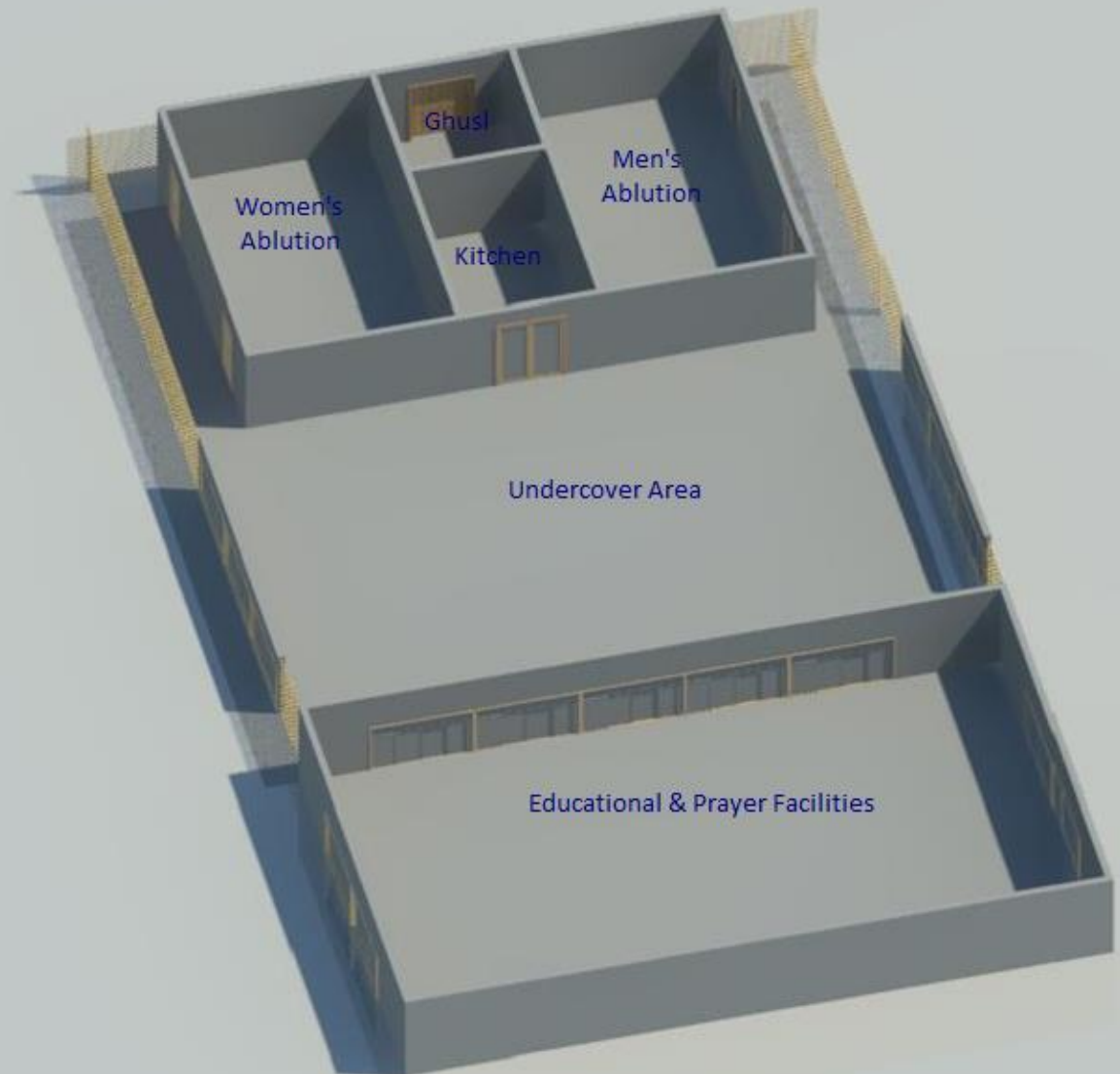

# 5 BUILDING INCLUSIONS

Inclusions	Profile
Educational facilities	Lecture rooms for formal Islamic courses, revert programs, hifz, madressa classes and community workshops.
Prayer facilities	<p>The prayer area is designed to accommodate 400 worshippers with additional provisions available in other areas if required.</p> <p>Salaat facilities will be available five times a day, Jummah, Tarawih and Eid.</p>
Kitchen & canteen	Food preparation area to cater for daily iftar in Ramadan and other auspicious occasions.
General amenities	Includes bathroom and wudu facilities along with a separate ghusl area.
Undercover area	A modern designed area that provides a connection between buildings that will serve as a gathering point for the community on a social level.

# PRAYER FACILITIES





# UNDERCOVER AREA



# 6 BUILDING LAYOUT

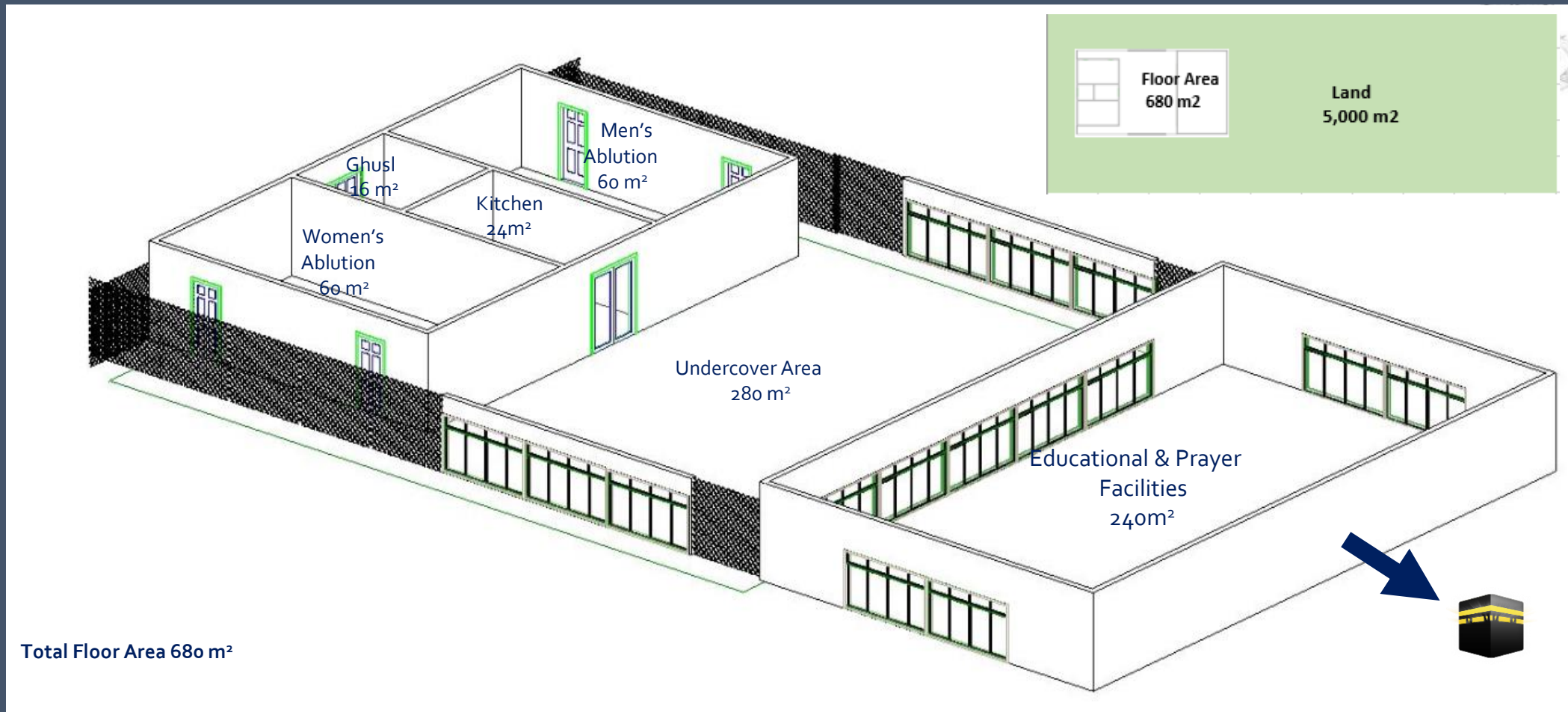

Providing  
an  
Extensive  
Range of  
Community  
Support  
and  
Services



# 7 BUILDING COST

Area	M <sup>2</sup>	Cost - AUD
Educational & Prayer Facilities	240	391,200
Ablutions	120	195,600
Ghusl	16	26,080
Kitchen & Canteen	24	39,120
Undercover Area	280	238,000
<b>Total Area</b>	<b>680</b>	<b>\$890,000</b>

# 8 HOW YOU CAN HELP



AI Mustapha Institute

Account Name: Al-Mustapha Institute of Brisbane

Swift Code: WPACAU2S

BSB: 034115

Account: 408001

All donations are fully tax deductible

39 Bushmills Court, Hillcrest QLD 4118, Brisbane Australia

Phone: +61 (7) 3809 4600      info@almustapha.org.au

Australian Business Number (ABN): 53 192 183 719

Registered Charity with the Australian Charities and Not-For-Profit Commission

